

Auxiliary display: ADI419

(for METTLER TOLEDO 4 Series)

Having the right results at first glance – even under harsh environments

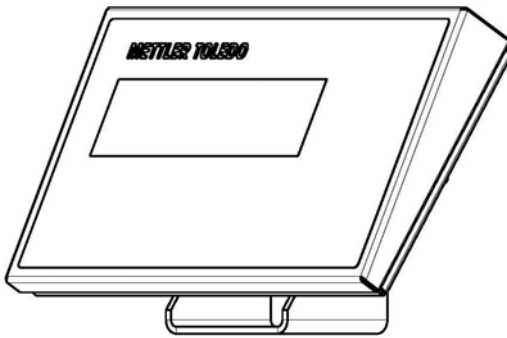

- Protected according IP69K (EN60529)
 - Stainless steel housing
- Attachable to wall, stand and desk

Technical Data

Enclosure / Environment	
Material	Steel AISI 304, 1.4301
Ambient temperature	-10° to +40°C
Humidity	- 80% rel. non-condensating
Net Weight	Incl. wall / stand / desk mount: 1.3 kg
Approvals / assessments	
Electrical Safety	CSA – C US, CE
IP protection:	Acc. IP69 (EN60529)

Display	
7-digits 7-segment LC-Display (also available with backlit ADI419-B)	
Character height	21mm
Connection to scale / weighing indicator	
Connection and power supply via RS232 interface	
Cable length:	3m
Mode:	2 nd display
Baud Rate:	9600
Parity:	8 none
Handshake:	XonXoff

ADI419 Dimensions (in mm)

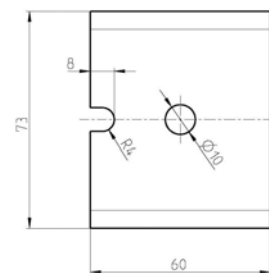
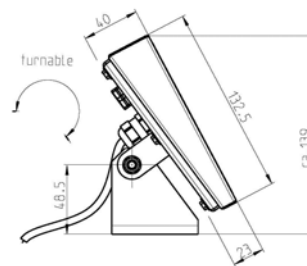
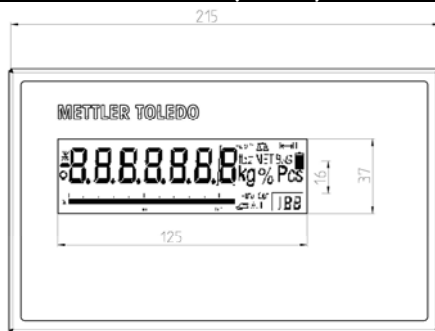

Accessories	
Stand, height 330mm for PBA430 platform	22013456
Stand, height 660mm for PBA430 platform	22013457
Stand, height 330mm for PBA330 platform	22011469
Stand, height 660mm for PBA330 platform	22011470
Floor stand, height 1065mm, painted	22012637
Floor stand, height 1065mm, stainless steel	22011981